

CYNTEC CO., LTD.

乾坤科技股份有限公司

HCB1190 Series

Mechanical dimensions

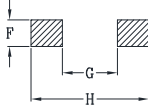
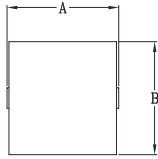

Suggested PWB Layout

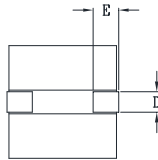

Dimensions (Unit : mm)

	0.63mΩ	0.31mΩ	0.42mΩ
A	11.2 MAX	11.5 MAX	11.2 MAX
B	11.2 MAX		
C	9.0 MAX		
D	2.0	2.2	1.9
E	2.5		
F	2.54		
G	5.3		
H	11.5		

Electrical Characteristics @ 25°C, 100kHz, 1V

Delta P/N	L ¹ (nH)	Li (nH)	DCR (mΩ)	Isat ² (A)			Ir ³ (A)
				25°C	100°C	125°C	
HCB1190-221	220	180	0.63 ± 9.5%	79	64	59	35
HCB1190-251	250	200		63	51	47	
HCB1190-271	270	216		58	47	43	
HCB1190-321	320	260		53	43	40	
HCB1190-361	360	288		48	39	36	
HCB1190-381	380	304		45	37	34	
HCB1190-471	470	376		36	29	27	
HCB1190-551	550	440		28	23	21	
HCB1190-221L	220	180	0.31 ± 9.5%	79	64	59	50
HCB1190-251L	250	200		63	51	47	
HCB1190-271L	270	216		58	47	43	
HCB1190-321L	320	260		53	43	40	
HCB1190-361L	360	288		48	39	36	
HCB1190-381L	380	304		45	37	34	
HCB1190-471L	470	376		36	29	27	
HCB1190-551L	550	440		28	23	21	
HCB1190-221L1	220	180	0.42 ± 9.5%	79	64	59	42
HCB1190-251L1	250	200		63	51	47	
HCB1190-271L1	270	216		58	47	43	
HCB1190-321L1	320	260		53	43	40	
HCB1190-361L1	360	288		48	39	36	
HCB1190-381L1	380	304		45	37	34	
HCB1190-471L1	470	376		36	29	27	
HCB1190-551L1	550	440		28	23	21	

1. Tolerance of inductance : ± 20%
2. Isat is the DC current which causes the inductance drop to Li
3. Ir is the DC current which causes the surface temperature of the part increase approximately 40 °C.
4. Operating temperature: -40°C to 125°C (Self-temperature rise included).